

# Easy As 1-2-3!

**IMPORTANT!** With finger **off** trigger, place spray can on stable surface and rotate can until spray tip opening points away from you. Then follow these 3 easy steps:

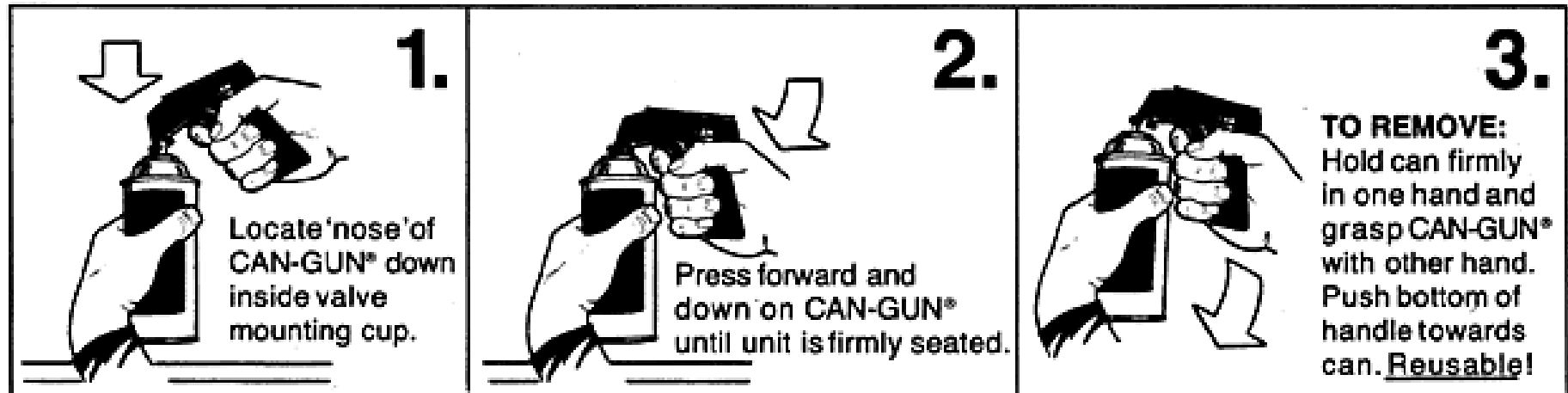

**Comfortable Trigger Action:** No more tired, cramped or frozen fingers. Award Winning **Comfort-Fit** design allows for even, continuous spraying. Saves time and makes all your spray jobs easier while **eliminating finger fatigue!**

**Accurate Spray Control:** CAN-GUN® provides complete control over the amount, speed and direction of spray cans of paints, lubricants, adhesives, cleaners, insecticides and more... **with professional results everytime!**

**Built-In Safety Shield:** Keep sprays from coming into contact with fingers, hands and face! Helps prevent accidental spraying... **everytime!**